

# INOX

*Pre-rinse Units  
and Water Taps*

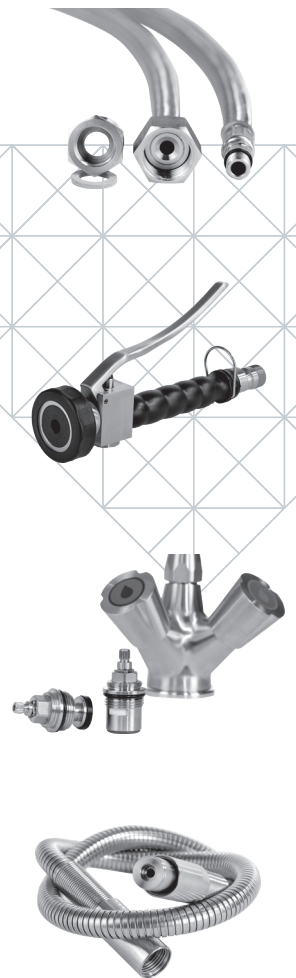

# PRE-RINSE UNITS AND COMPONENTS IN STAINLESS STEEL



## PRE-RINSE UNITS AND WATER TAPS PRODUCT RANGE **INOX**

- Stainless steel
- Stylish design with frosted surface
- In-house assembly followed by strict quality controls



With an additional connection adapter for 1/2"÷ 3/8"  
for easy and smooth installation

# PRE-RINSE UNITS AND COMPONENTS IN STAINLESS STEEL



LF Code: 5118026  
GEV Code: 549485

## STAINLESS STEEL FLEX HOSE 1000 mm ø 1/2"

Stainless steel braided hose with bend protection on both sides (KTW approved) ensures high durability. Best quality on the market



LF Code: 3360029  
GEV Code: 546509

## STAINLESS STEEL SPRAY GUN ø 1/2"M

Elegant and solid spray gun



- Double o-ring seals for enhanced sealing of the components.
- Spout (ø 25mm) provided additionally with a swivel nut.

# PRE-RINSE UNITS WITH MONOBLOC TAP

**STAINLESS STEEL**



LF Code: 5133173  
GEV Code: 595009

## PRE-RINSE UNITS WITH MONOBLOC TAP

3/4" tap heads allow maximum water flow  
Connection adapters in 1/2"÷ 3/8" are part of the basic equipment

A PRODUCT FOR ALL  
SECTORS WHERE THE  
HIGHEST STANDARDS  
ARE REQUIRED.



LF Code: 3360030  
GEV Code: 542574

## FLEX HOSE SET STAINLESS STEEL

set including:  
Flex hose, 800 mm, 100% stainless steel  
Adapter thread 1/2"÷3/8"  
Backflow preventer 1/2"

# PRE-RINSE UNITS WITH TWO HOLES

**STAINLESS STEEL**



LF Code: 3360028  
GEV Code: 595042

## PRE-RINSE UNITS WITH TWO HOLES

Top-quality ø 47mm ceramic valve cartridge - Connection 1/2"

OUR INOX PRODUCTS ARE  
CHARACTERIZED BY ITS ELEGANT  
DESIGN AND ROBUST QUALITY.

At REPA, you can get INOX pre-rinse units in  
all common variants: as monobloc, with  
twin-holes or for wall mounting.



MORE INOX PRE-RINSE UNITS CAN BE  
FOUND IN THE REPA WEB SHOPS:

[www.gev-online.com](http://www.gev-online.com)  
[www.lfspareparts724.com](http://www.lfspareparts724.com)



# WALL-MOUNTED PRE-RINSE UNITS

**STAINLESS STEEL**



LF Code: 3360032  
GEV Code: 595077

## WALL-MOUNTED PRE-RINSE UNITS - INOX AUTOMATIC

Water flow is activated by pulling the spray gun  
Built-in pressure spring prevents the spray head from springing back and enables ergonomic working

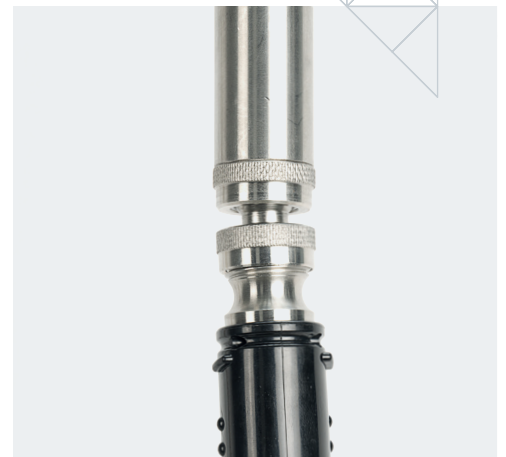
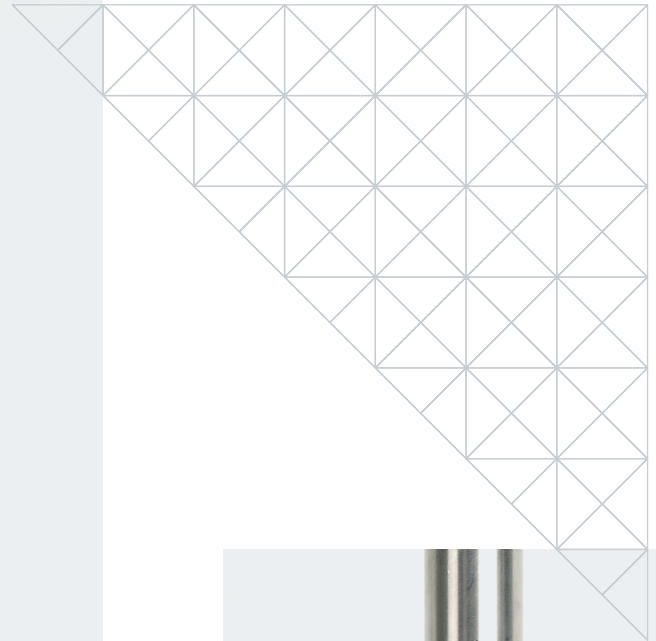

Practical swivel adapter with ball joint for large radius of action

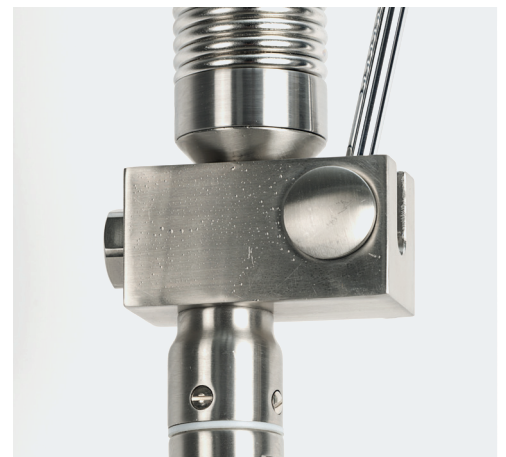

High-quality automatic valve made of stainless steel components

# WATER TAPS 3/4"

STAINLESS STEEL



LF Code: 3259047  
GEV Code: 595361

## INOX PRE-RINSE UNITS AND WATER TAPS:

- Easy cleaning
- Meet the highest hygiene standards
- Long service life even under heavy load

## WATER TAPS WITH COLUMN

Column height 260 mm  
Spout length 350 mm  
With high-quality ø 47 mm  
ceramic valve

MORE INOX WATER TAPS CAN BE  
FOUND IN THE REPA WEB SHOPS:

[www.gev-online.com](http://www.gev-online.com)  
[www.lfspareparts724.com](http://www.lfspareparts724.com)





**GEV Großküchen-Ersatzteil-Vertrieb GmbH**

Gadastr. 4  
85232 Bergkirchen - Germany  
T +49 8142 6522-50  
info.ger@repagroup.com  
www.gev-online.com

**LF S.p.A. a socio unico**

Via Voltri 80  
47522 Cesena FC - Italy  
T +39 0547 341111  
info.it@repagroup.com  
www.lfspareparts724.com

**EPGC S.a.s.**

13 Rue des Forts  
59960 Neuville en Ferrain - France  
T +33 3 20250621  
france@repagroup.com  
www.epgc.com

**Commercial Catering Spares Ltd.**

Block C - Axis Point Hill Top Road  
Heywood - Lancashire - OL10 2RQ - UK  
T +44 1706 621 155  
info@ccspares.co.uk  
www.ccspares.co.uk

**Atel S.r.l. a socio unico**

Via Selvuzzis 51/2  
33100 Udine UD - Italy  
T +39 0432 602095  
info@atelitalia.com  
www.atelitalia.com

[www.repagroup.com](http://www.repagroup.com)

